

**Application to vary a club premises certificate to be granted
under the Licensing Act 2003**

PLEASE READ THE FOLLOWING INSTRUCTIONS FIRST

Before completing this form please read the guidance notes at the end of the form. If you are completing this form by hand please write legibly in block capitals. In all cases ensure that your answers are inside the boxes and written in black ink. Use additional sheets if necessary.

You may wish to keep a copy of the completed form for your records.

PRESTON CONSERVATIVE CLUB

(Insert name of club)

club applies for a club premises certificate under section 84 of the Licensing Act 2003 for the premises named in Part 1 below

| | |
|----------------------------------|---------|
| Club premises certificate number | CP 0032 |
|----------------------------------|---------|

Part 1 – Club premises details

| | | | | | | | | | |
|---|--|----------|--|-----------------------------------|----------|--|---------|--|--|
| Name of club | | | | PRESTON CONSERVATIVE CLUB | | | | | |
| Postal address of premises, if any, or if none ordnance survey map reference or description | | | | | | | | | |
| 299 TORQUAY ROAD | | | | | | | | | |
| PAIGNTON | | | | | | | | | |
| Post town | | PAIGNTON | | | Postcode | | TQ3 2EY | | |
| Telephone number (if any) | | | | 01803 557772 | | | | | |
| E-mail address (optional) | | | | wendy@prestonconservativeclub.com | | | | | |

| | | | |
|---|------------------|----------|--|
| Name of person performing duties of a secretary to the club WENDY JANET HOLMES | | | |
| Address of person performing duties of a secretary to the club 299-301 TORQUAY ROAD PAIGNTON. TQ3 2EY. | | | |
| Post town | | Postcode | |
| Daytime contact telephone number (if any) | 01234 | | |
| E-mail address (optional) | | | |

Part 2 – Applicant details

| | | | |
|---|--|----------|--|
| Daytime contact telephone number (if any) | | | |
| E-mail address (optional) | | | |
| Current postal address if different from premises address | | | |
| Post town | | Postcode | |

Part 4 – Club Operating Schedule

Please complete those parts of the Club Operating Schedule which would be subject to change if this application to vary is successful.

What qualifying club activities do you intend to conduct on the club premises which will be affected by your application?

Provision of regulated entertainment

Please tick as appropriate

- a) plays (if ticking yes, fill in box A)
- b) films (if ticking yes, fill in box B)
- c) indoor sporting events (if ticking yes, fill in box C)
- d) boxing or wrestling entertainments (if ticking yes, fill in box D)
- e) live music (if ticking yes, fill in box E)
- f) recorded music (if ticking yes, fill in box F)
- g) performances of dance (if ticking yes, fill in box G)
- h) anything of a similar description to that falling within (e), (f) or (g) (if ticking yes, fill in box H)

The supply of alcohol by or on behalf of a club to, or to the order of, a member of the club (if ticking yes, fill in box I)

The sale by retail of alcohol by or on behalf of a club to a guest of a member of the club for consumption on the premises where the sale takes place (if ticking yes, fill in box J)

In all cases complete boxes K, L and M

| Supply of alcohol Standard days and timings (please read guidance note 7) | | | <u>Will the supply of alcohol be for consumption – please tick</u> (please read guidance note 8) | On the premises | <input type="checkbox"/> |
|--|-------|---------------------------|--|---------------------|-------------------------------------|
| | | | | Off the premises | <input type="checkbox"/> |
| | | | | Both | <input checked="" type="checkbox"/> |
| Day | Start | Finish | | | |
| Mon | 10:00 | 00:30 01:00 | <u>State any seasonal variations</u> (please read guidance note 5) HOURS FOR SALE OF ALCOHOL INSIDE THE PREMISES UNCHANGED FROM EXISTING PERMISSIONS AS SHOWN ON THE LEFT. HOURS FOR SALE OF ALCOHOL FOR CONSUMPTION IN THE GARDEN AREA (AS SHOWN ON PLAN) TO BE RESTRICTED TO 10:00 HRS TO 21:00 HRS DAILY. | | |
| Tue | 10:00 | 00:30 01:00 | | | |
| Wed | 10:00 | 00:30 01:00 | | | |
| Thur | 10:00 | 00:30 01:00 | | | |
| Fri | 10:00 | 00:30 01:00 | | | |
| Sat | 10:00 | 00:30 01:00 | | | |
| Sun | 12:00 | 22:30 23:00 | | | |
| | | | <u>Non-standard timings. Where the club intends to use the premises for the supply of alcohol at different times from those listed in the column on the left, please list</u> (please read guidance note 6) | | |
| | | | AS CURRENT LICENCE FOR CHRISTMAS EVE AND NEW YEARS EVE | | |

J

| Hours club premises are open to the members and guests Standard days and timings (please read guidance note 7) | | | State any seasonal variations (please read guidance note 5) ALL OPENING HOURS AS CURRENT LICENCE |
|--|-------|--------|--|
| Day | Start | Finish | |
| Mon | | | |
| Tue | | | |
| Wed | | | |
| Thur | | | |
| Fri | | | |
| Sat | | | |
| Sun | | | |
| | | | |

K

Please highlight any adult entertainment or services, activities, other entertainment or matters ancillary to the use of the premises that may give rise to concern in respect of children (please read guidance note 9).

NONE

M - Describe the steps you intend to take to promote the four licensing objectives:

a) General - all four licensing objectives (b, c, d and e) (please read guidance note 10)

- 1) CCTV TO BE IN OPERATION AT ALL TIMES INCLUDING THE GARDEN AREA
- 2) INDIVIDUALS WHO APPEAR INTOXICATED SHALL NOT BE SERVED
- 3) CUSTOMERS SHALL NOT BE PERMITTED TO LEAVE THE PREMISES WITH THEIR GLASSES

b) The prevention of crime and disorder

- 1) VIOLENCE OR AGGRESSIVE BEHAVIOUR, TOWARDS STAFF OR CUSTOMERS SHALL NOT BE TOLERATED AND ANY INDIVIDUAL HAVING AN AGGRESSIVE DEMEANOUR SHALL BE ASKED TO LEAVE THE PREMISES.
- 2) THERE SHALL BE NO CONSUMPTION OF DRINKS FROM BOTTLES IN THE GARDEN AREA; ALL DRINKS (INCLUDING CHILDRENS DRINKS) SHALL BE DECANTED INTO APPROPRIATE GLASSWARE

c) Public safety

- 1) GLASSES SHALL BE CLEARED ON A REGULAR BASIS
- 2) TABLES IN THE GARDEN AREA SHALL BE CLEARED OF EMPTIES WHETHER TABLES ARE OCCUPIED OR NOT.

d) The prevention of public nuisance

e) The protection of children from harm

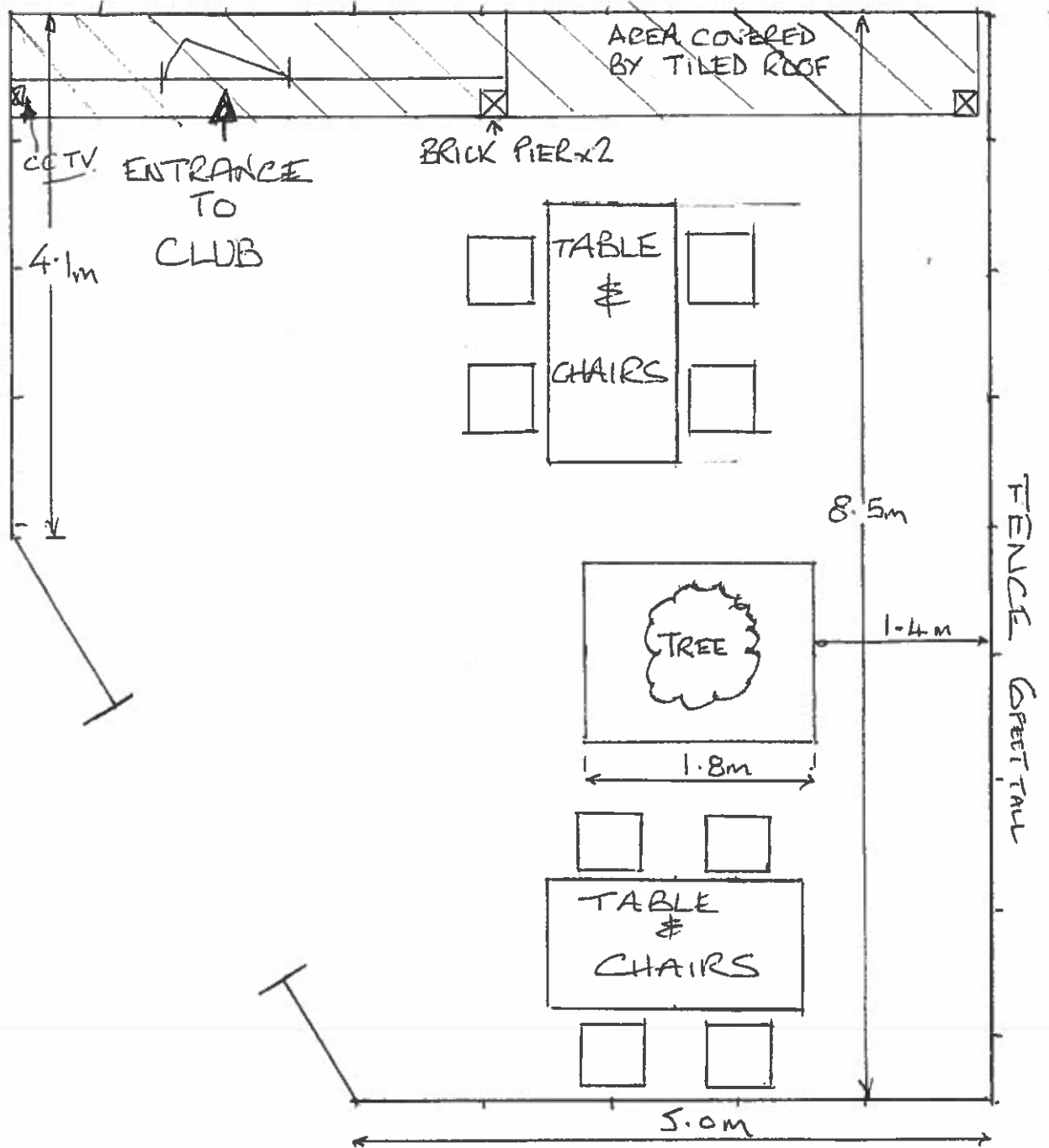

PRESTON CONSERVATIVE CLUB -
 299-301 TORQUAY RD.
 PAIGNTON
 TQ3 2EY.